



ROPE HAMMOCK INSTRUCTIONS

TIP FOR NEW OWNERS: Inspect your hammock prior to each use to ensure it's still hanging correctly and is in overall safe condition.

In the Box:

- Hammock with chains
- 2 tree hooks

TOOLS YOU'LL NEED:

- Drill with 1/8 inch inch bit
- Adjustable wrench or screwdriver

★ **NO tools or tree hooks needed if using a hammock stand.**

HEIGHT TO INSTALL TREE HOOKS (in inches)

Hammock Length*	Distance Between Trees/Posts					
	10 feet	11 feet	12 feet	13 feet	14 feet	15 feet
11 feet	66"	54"	48"	48"	48"	48"
12 feet	84"	72"	60"	48"	48"	48"
13 feet	96"	84"	72"	60"	48"	48"
14 feet	108"	96"	84"	72"	60"	48"

Heights in shaded areas not recommended and may give hammock such a pronounced arch as to be uncomfortable.

** Distance measured from ring to ring when hammock laid flat on floor. Note that new hammock may be up to 2 feet shorter than its specifications, to allow for ropes' natural tendency to stretch the first few times it's used.*

HANGING YOUR HAMMOCK

1. Choose two sturdy wooden surfaces (trees, posts, wall studs, etc.), each at least 6 inches (15 centimeters) in diameter. Hanging space should be 18-24 inches greater than total hammock length, from O-ring to O-ring. Note: The closer the anchor points, the greater the hammock's curve once hung. **To hang your hammock from any surface other than wood, consult a building professional for proper method and additional supplies required for safe installation.**
2. Refer to the "HEIGHT TO INSTALL TREE HOOKS" chart above for how high to place your tree hooks.
3. To install tree hooks, drill 1/8 inch pilot holes into both your chosen trees or other wooden surfaces. Start a hook in each hole by hand, then grip the hook eye with a wrench or thread the eye with a screwdriver to twist all the way in. Stop when the eye makes contact with wood; do not over-twist. **Refer to diagrams above.**
4. Hook the free ends of the chains on each side of your hammock over your newly installed hammock hooks, using the chain links to adjust height and tautness. Sit carefully in your hammock allowing the ropes to stretch. Then adjust the chain to once again tighten your ropes. **Refer to diagrams below.**

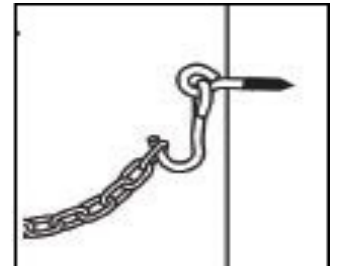
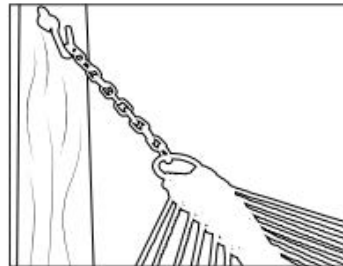
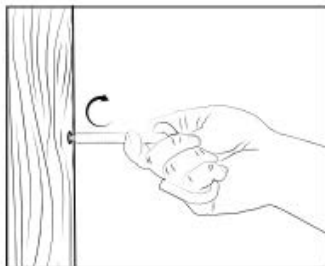
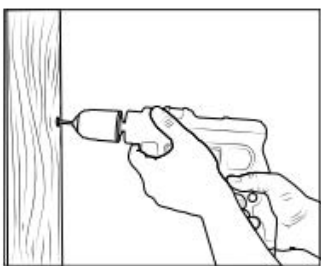

Weight Limit: 450 lbs

Congratulations! You now own a Pawleys Island Rope Hammock that was proudly handcrafted in the Carolinas. We hope you will have many years of comfort and enjoyment.

PAWLEYS ISLAND HAMMOCKS

(252) 758-0641

www.pawleysislandhammocks.com

10880 Ocean Hwy Bldg 1

Pawleys Island, SC 29585

Getting in or out of a hammock can seem tricky at first. Be sure to sit down first in the hammock before putting your feet up. Center yourself in the hammock since getting over to one side makes it feel unstable. Many people enjoy stretching out across the hammock with their feet still on the ground to rock themselves.

NOTE: The hammock rope will continue to stretch with use as it reaches its full size. It will require adjustment to the height by further adjusting chain lengths.

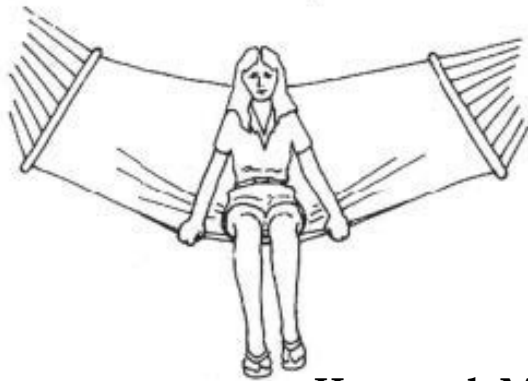

Weight Limit: 450 lbs

Hammock Maintenance

- Take down your hammock and store it during prolonged bad weather. Repeated exposure to rain, snow and sleet may shorten your hammock's life and affect its appearance.
- Squirrels, mice, birds and bugs sometimes use hammock rope fibers to build nests and to live in, so always inspect your hammock before getting into it. •Dogs, especially puppies, often regard hammocks as great chew toys, so dog owners should hang, and store, their hammocks somewhere Rover can't easily reach.
- Avoid storing near strong chemicals, including pesticides.
- To clean your hammock, stretch it out on a clean, dry, non-abrasive surface, wet it with a hose and gently scrub the ropes with a soft brush and a mild detergent/warm water solution. Unless your hammock is woven from our Duracord® rope, DO NOT use any cleaning product containing bleach or other strong chemicals.
*If you have purchased a Pawleys Duracord® rope hammock, you may use a 5 to 1 (water to household bleach) solution on stubborn stains. Take care to protect wood parts, if possible. After washing the hammock, rinse it thoroughly and allow it to air dry completely before hanging it or storing it.

TIP FOR NEW OWNERS: Inspect your hammock prior to each use to ensure it's still hanging correctly and is in overall safe condition. **To achieve desired height, a new hammock will require prestretching. If not using one of our hammock stands, inspect hanging structure prior to assembly and before each use.**

WARRANTY & RETURNS - Pawleys Island Hammocks products are guaranteed to be free of defects in both workmanship and material for up to one year from the date of purchase. Prolonged exposure to weather conditions including snow, rain, and humidity are not covered under the warranty, nor is damage caused by negligence, normal wear, mildew, or improper care, including storage, maintenance, and assembly. If you are not satisfied with an item, return it unused in its original packaging for a complete refund or exchange. You can return it to our store or to our warehouse, Pawleys Island Hammocks, 305 Industrial Blvd., Greenville, NC 27834. **Note that an original sales receipt must accompany any returned product, along with a Return Authorization Number from Pawleys Island Hammocks customer service; call (252) 758-0641.**

Installation methods not included in these instructions are not recommended. Inspect wooden beams used for installation prior to hanging and before each use.